

13-11-2008
4600 Køge
Københavnsvej 203
Dansk Auto Hi-Fi A/S. Køge
Högtalare Earthquake DBXI-10D
F-3dB vid 44.5Hz materialtjocklek 22mm
1.43 Spl: 120dB
Sluten låda totalvolym 20l. Qtc=

av Johan Lindberg.
Backlunds Ljudbyggeri. Programmering
Ritningen gjord med ProBox 2000 från

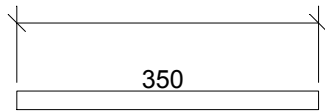

Djup 450

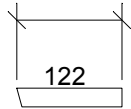

75°

Djup 450

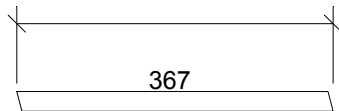

75°

Djup 450

75°

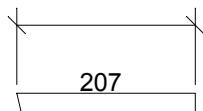

75°

Djup 450

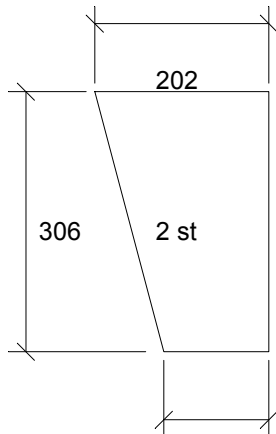

122

