

13-11-2008
4600 Køge
Københavnsvej 203
Dansk Auto Hi-Fi A/S. Køge
Högtalare Earthquake SWS10
F-3dB vid 51.5Hz materialtjocklek 22mm
ø70 mm. Spl: 122dB
Basreflex totalvolym 18l. 1 rör 380x

av Johan Lindberg.
Backlunds Ljudbyggeri. Programmering
Ritningen gjord med ProBox 2000 från

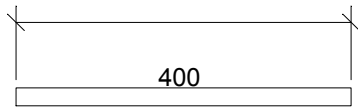

Djup 700

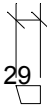

75°
Djup 700

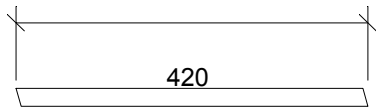

75°

Djup 700

75°

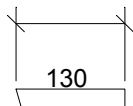

75°

Djup 700

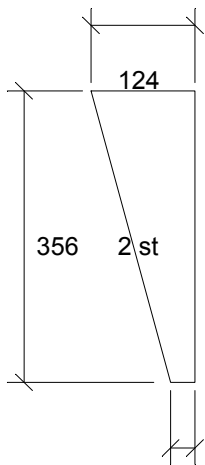

29

